

# KS EVO VS

ENERGY SAVINGS AND VERSATILITY,  
WITH SILENT OPERATION



Low



Permanent  
Magnet Motor



Union fittings provided, 50 and 63 mm  
diameter, to fit in any existing installation

- ➔ Variable speed: high efficiency for each application, optimised consumption
- ➔ 5 programs, 3 preselected speeds
- ➔ Super-silent operation
- ➔ Wing-nut closing system, rapid access (no tools required)
- ➔ Double drain, easy opening (no tools required)
- ➔ Simple installation, direct substitute for KSE pumps
- ➔ Impeller and diffuser made of Noryl®, very hard-wearing and corrosion-resistant
- ➔ Permanent magnet motor
- ➔ Automatic "Skimming" function: cleans the surface every 1, 2 or 3 hours
- ➔ Usage: for residential pools up to 96 m<sup>3</sup>
- ➔ Prefilter size: 3.5L

Code	Ref.	HP	P2 (W)	P1 (W)	Amps (A)	A (mm)	Flow rate (m <sup>3</sup> /h)*	Weight (kg)	Pack. (mm)	qty/pallet
010925101520	KS Evo VS	1.50	1104	1250	5.9	543	21	15	330 x 255 x 650	25

P1 Input power - P2 Output power

\* 10 m water column pressure

M.O.Q. :1



**LPRK Smart retrofit kit: use it with the KS EVO VS to replace easily old pumps on existing installations**

#### SMART RETROFIT KIT

Item	Pumps to replace	Kit content	Kit per box
LPRK	Astral Victoria Plus, Astral Victoria Plus Silent, Saci Winner	Smart Base (1), Fixing screw (3), RC50 (2), O-ring Seal (2)	10

LPRK is valid to retrofit installations Ø50 mm, commonly used for pumps up to 1 HP

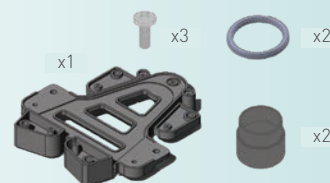

#### Technical Specifications

Max. water temp. / Max. pressure	50°C / 2,5 bar
Connection (DIN slip included, for others please ask)	Ø 50 - 1 1/2" and Ø 63 - 2" All bodies have a 2" thread, possibility of having AINSI connection
Mechanical seal	AISI 316, suitable for salt water
Motor-drive specifications	Class F, IP55, 50 Hz, single phase
Housing/impeller/strainer/lid	PP + F.G./Noryl®/PP/SAN®

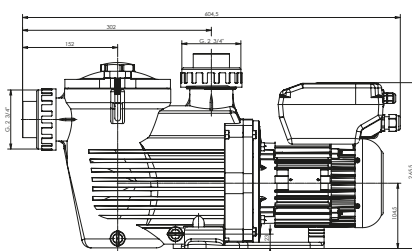
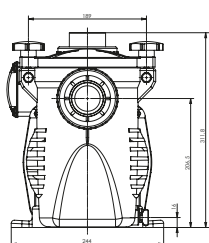

**Single Speed models can be easily replaced with a VS equivalent.**

(No need to retrofit or modify hydraulic connections).

Water column pressure (m)

